

Pasquotank County Property Card

as of July 1, 2021

PIN: 891416838786

PID: 0064624

MAP: P144-1A

Deed Book: 1220 / Deed Page: 360 / Date: 20150211

Location: 00108 WARD ST

Prior Evaluation Year: 2006 Current Evaluation Year: 2014

Land	\$464700	\$418200
Use Land	\$0	\$0
Building	\$62800	\$380200
Total	\$527500	\$798400
Assessed	\$527500	\$798400

FELTON, ARTHUR T SR & ANGELA J  
931 HALLS CREEK RD

ELIZABETH CITY, NC 27909

Acct: 0126147

Estimated County Tax (.0077): \$6147.68

Estimated City Tax (.0074): \$5908.16

Notes 20201014

Storm Water Fee: \$1023.66

Solid Waste Fee: \$144 (\$75 for Elderly/Disabled with Exclusion)



[Click here to send us a new/better picture](#)

Building Data

Year Built 1946 Grade: C

Number of Units 1

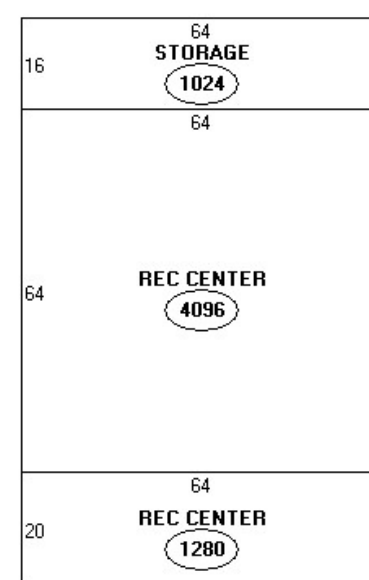

Descriptor/Area  
 A: REC CENTER 4096 sqft  
 B: STORAGE 1024 sqft  
 C: REC CENTER 1280 sqft

Building Data

Year Built 1960 Grade: C

Number of Units 0

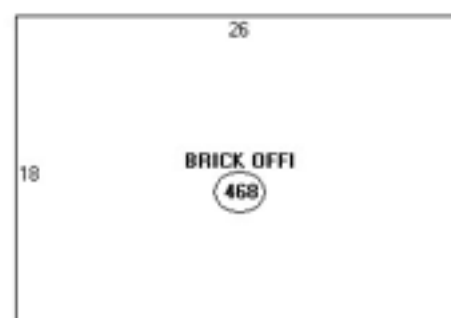

Descriptor/Area  
 A: BRICK OFFI 468 sqft

Land

Primary 2.35 acres @ \$197762.4/acre \$464742.0

Total Acres: 2.35 Total Land Value: \$418200



891416838786 Aerial P144-1A

Land

Total Acres: 2.35 Total Land Value: \$418200



891416838786 Aerial P144-1A

Sales Data

Date	Type	Price	Source	Owner	Deed	Assessment
20150211	Land & Bldg	200000	Stamps	W W OWENS & SONS MOVING & STORAGE INC	1220/360	477200

[Tax Ownership Book \(for research only\)](#)

OUTBUILDING DATA

Type	Qty	Year	Size1	Size2	Grd	Cnd	Value
------	-----	------	-------	-------	-----	-----	-------